

1. STEP

On the main page of your Members area, click on "**Add account**". Creating a new account is only possible **after successful verification** of your documents.

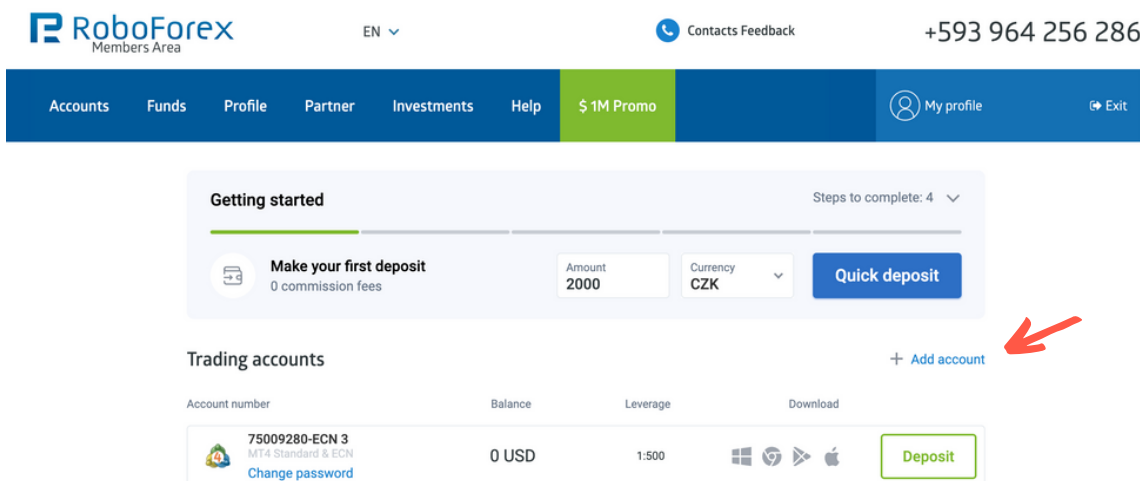

2. STEP

You will then set the trading account parameters in the form as instructed.

ATTENTION: this step is very **important**, without the correct settings you will **not be able** to connect to the strategy. Enigma Easy and Enigma Profi have **different account settings**.

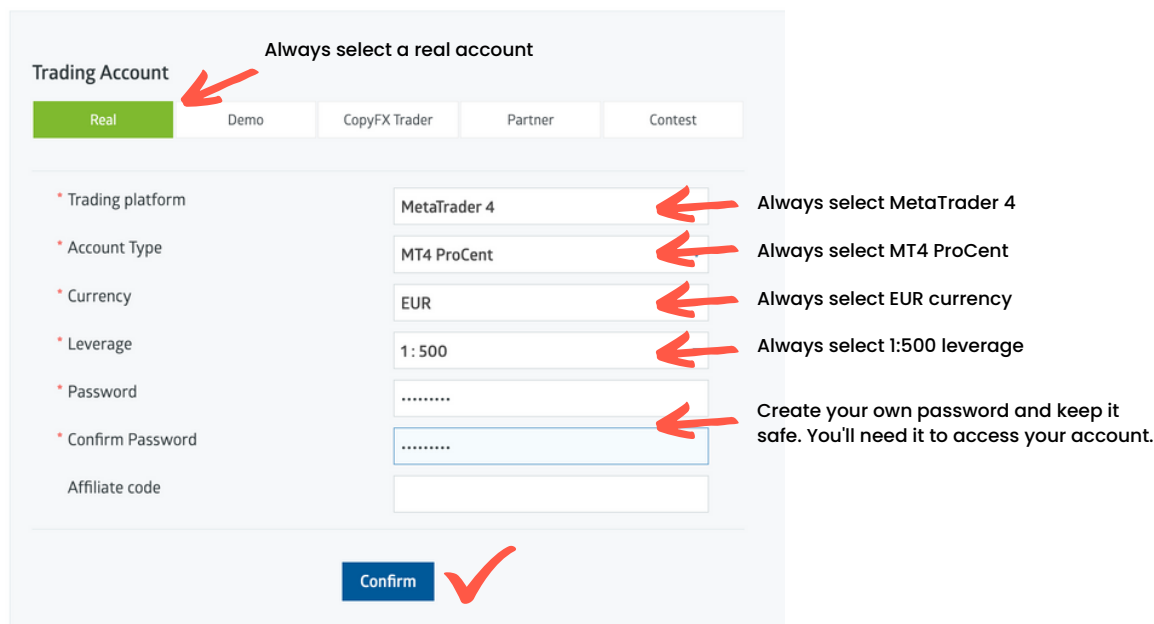

ENIGMA EASY

Creating a trading account



3. STEP

Your **new EUR trading account** will then be created and you will find it on the main page of your Members area.

Just below it you will also see a very similar account in **USD currency**, which is always created automatically upon registration. You will **not need or use this USD account**.

This is the EUR account you are going to **deposit** and **connect** to the strategy.

NOTE: This USD trading account is not needed, ignore it or deactivate it in the "Account management".

4. STEP

You are now ready to **deposit funds** into your newly created trading account.